

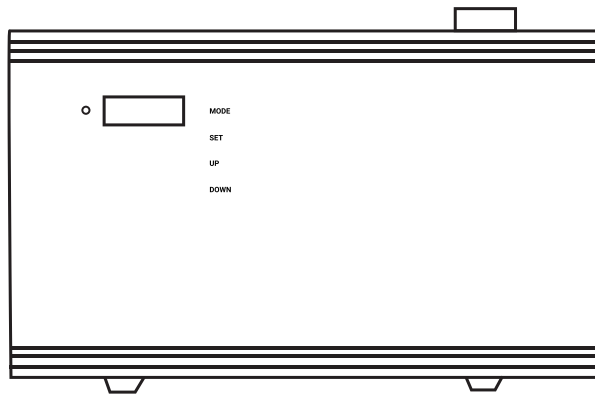

PRODUCT MANUAL



SCENT DIFFUSER MACHINE



IMPORTANT

Please comply with the following for safety reasons.



Do not modify or disassemble the scent machine without first consulting our service people.

In case of product failure please contact us.



Do not use the power cord if it is damaged, kinked or cut. It's a fire hazard.



To avoid electrical shock, do not touch the power adaptor or the machine while plugged into the electrical socket during a thunderstorm or lightning.



Do not dismantle or try to repair the machine while its plugged into the electrical outlet or in operation

CONTENTS

DISCOVER THE POWER OF SCENTING!.....3

FEATURES.....4

TECHNOLOGY4

SPECIFICATIONS5

DIAGRAM OF PARTS.....6

ACCESSORIES.....6

WHERE TO PLACE THE DIFFUSER.....7

INSTALLATION INSTRUCTIONS8

TIMER SETTINGS.....10

INTENSITY SETTING.....12

WORKING GROUP SETTING.....14

MAINTENANCE.....16

TROUBLESHOOTING.....17

CAUTIONS.....18

FAQS.....20

DISCOVER THE POWER OF SCENTING!

Scent is a fantastic way to express yourself, reduce stress, enhance happiness, give your memory a boost, increase your energy, sleep better, and uncover a host of other benefits. The diffuser will change the way you think about scents and reveal a multitude of ways to use in your home or business. Simply add your favorite scents and transform your space in to whatever you need it to be. The diffuser allows you to easily tailor your scent experience to your preferences and your space. With unique cold-air diffusion technology, this diffuser scents your environment subtly and consistently while preserving the quality of your 100% Essential or Aroma Oils.

Its sleek design and modern aesthetic look will help you make any space more inviting and vibrant.

FEATURES

- Scents 300-1200 cubic meter of space
- cold-air diffusion technology that subtly disperses fragrance oils in to the air
- Wall mount or stand-alone
- Adjustable fragrance intensity and hours of operation
- Quiet and energy efficient
- Eco-friendly and made from recycled metal and glass
- No water or heat
- Leaves no residue

TECHNOLOGY

The machine uses cold-air diffusion technology to diffuse our aroma oil blends, this is a process that breaks down the oils into a very fine dry mist. Nebulization preserves the intention and integrity behind our oils while maximizing their olfactive and therapeutic powers, without diluting in water, solvent, or using heat.

This diffusion technology, combined with our commercial fragrance oil blends, produces nanoparticles that suspend in the air for several hours creating a clean and consistent ambient scent, without chemical undertones.

Commercial fragrance diffusers help to create an emotional connection with consumers by creating lasting impressions, memories, and multi-sensory responses, all while increasing energy, inspiring brand loyalty, improving sales, masking unpleasant odors, reducing dust, pet dander allergens, and other airborne allergens from non-living matter. Cold-air diffusers support healthy indoor air quality while providing ambiance and well-being for you, your employees, and clientele..

Diffusing essential oils helps to reduce dust, pet dander allergens, and other airborne allergens from non-living matter (e.g. dust mite matter allergens) while our 100% all natural diffuser blends bring nature's goodness into your space by supporting harmony and balance.

Using only our essential and aroma oil blends will guarantee the best performance of your diffuser. No mixing or diluting with water, carrier oils or alcohol is required. Simply fill the bottle with what nature created and enjoy!

SPECIFICATIONS

Model	Scent Pro
Dimension	300 x 245 x 124 mm
Machine N.W.	3.8kg
Voltage	Input: AC100V-240V 50/60Hz
	Output: DC12VIA
	Cable length: 120cm/3.93ft
Technology	Cold Air Diffusion Technology
Power	110-240 volt power source
Coverage	400 sq.m/1,200m ³ /4,000 sq.ft
Bottle capacity	300ml
Material	Machine: Aluminum, Glass
	Bottle: glass
	Nozzle: Aluminum, Brass
Accessories	Power adapter, Manual, Nails, Screws, Wall bracket.

DIAGRAM OF PARTS

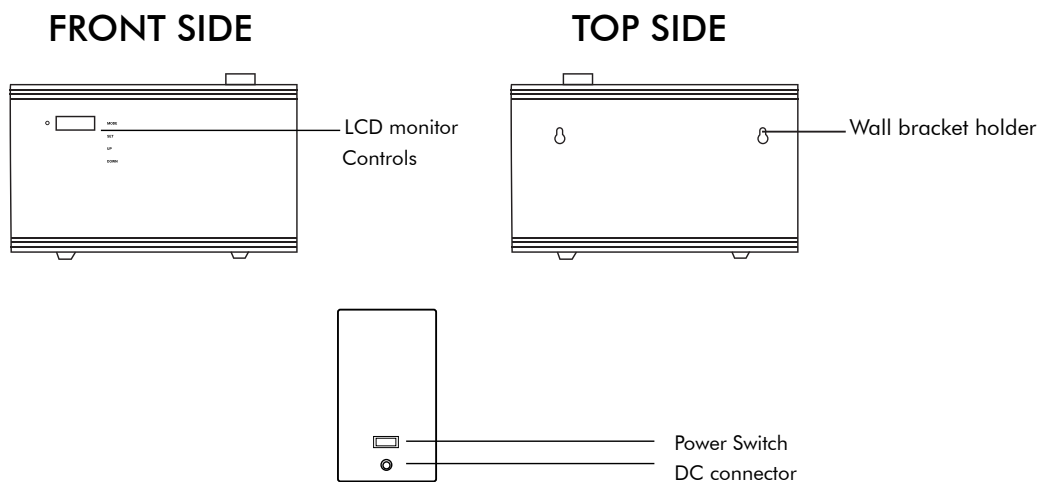

ACCESSORIES

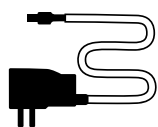

adaptor



Bottle



Manual



Screws, Nails

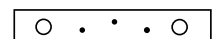

Mounting Bracket

Check and make sure the packaging is complete when you first open it if parts are missing, please contact us.

WHERE TO PLACE THE DIFFUSER

Applications: aromatherapy, ambient scenting and odor control in home or business.

Location: The ScentPro is designed to be used as a table-top, wall mount unit.

Scenting Coverage: ScentPro can be adjusted to scent an area ranging from 100 to 4,000 sq.ft. (10 to 400 sq.m)

Scent Intensity: Adjust your scenting experience and hours of operation through the internal touch LCD timer.

Device Location: The most important element of your scenting experience is to properly position the device in the room, to ensure optimal performance and control.

Below are our suggestions.

- Choose the location where the aroma oil molecules can use the natural airflow in a room. This is particularly important with air-conditioned spaces. The best location for the ScentPro is where there is a lot of airflow.
- If you are not sure of the direction of the airflow, simply turn on the ScentPro and using a flashlight point it at the scent output and watch where the scent will travels. Alternatively, light up a match and blow it out immediately. The direction of the scent or smoke will tell you which way the fragrance will travel.
- The ScentPro is a luxury and aesthetically beautiful device. Always keep it in an open area and do not hide it behind or under pieces of furniture.
- Try a variety of locations and settings until you are happy with the scent coverage. Give ScentPro a little time to adjust to the new location and setting before changing it again.

INSTALLATION INSTRUCTIONS

ScentPro can be used as a portable device, wall mounted. If you are wall mounting. please follow the below instructions. If you are using the device as a free-standing unit, please go to page 07 to set up the timer.

Parts and Tools Required

You will require the following tools to wall mount, If using ScentPro as a stand-alone or shelf top unit no installation or tools are required.

1. A level to ensure the wall mount bracket is exactly horizontal.
2. A hammer for the dry wall anchors.
3. A Philips screwdriver to match the screws provided or any other screwdriver that matches the screws to attach to the anchors you have selected.

Mounting Wall Bracket

1. Using drill bit make a hole in the drywall the size of the plug.
2. Insert the drywall plug. If needed tap lightly with a hammer to fully insert the plug.
3. Screw the bracket to the wall aligning with drywall plugs.

Wall Mounting:

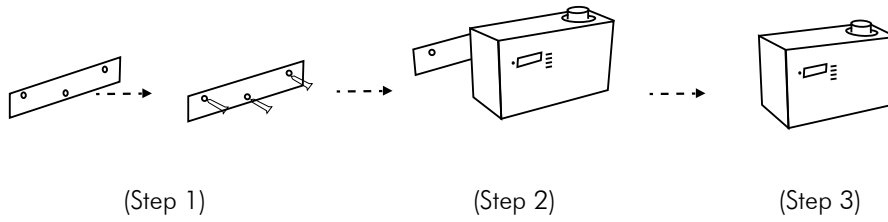

1. Always make sure the ScentPro is mounted straight up.
2. Attach the wall bracket with all the supplied screws or nails (depending on the surface).
3. Hang the machine on its hinges.

Filling the oil bottle:

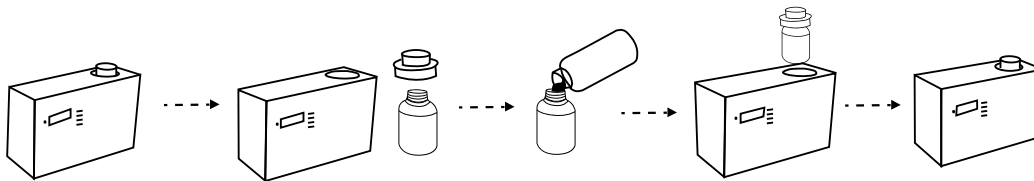

1. Unplug the machine from the outlet.
2. Pull the diffuser head upward.
3. Unscrew the bottle.
4. Fill the bottle with fragrance.
5. Screw the bottle back on the diffuser straight and snug.

Warning:

After installation, please keep the machine vertical. Tilting or placing it flat may cause an oil overflow. If the ScentPro is tilted, the oil will over flow inside and may potentially damage the machine.

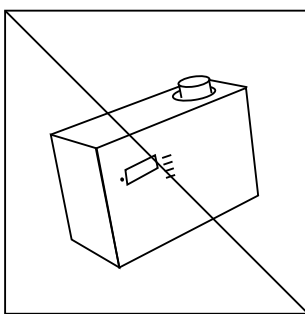

WRONG

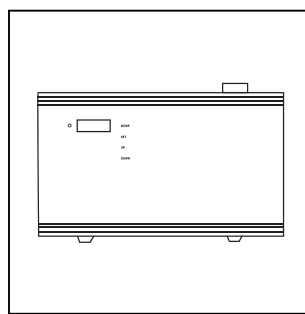

CORRECT

TIMER SETTINGS
Mon-Sun 7-day timer



local time

Power ON

Connect the 12V adaptor to the outlet and turn ON the power switch. Local time and scent intensity level will appear.

Screen Lock and Unlock

The LCD screen will automatically lock itself after 10 seconds if not used. Press SET and hold for 5 seconds to unlock the display.

Set local time and week

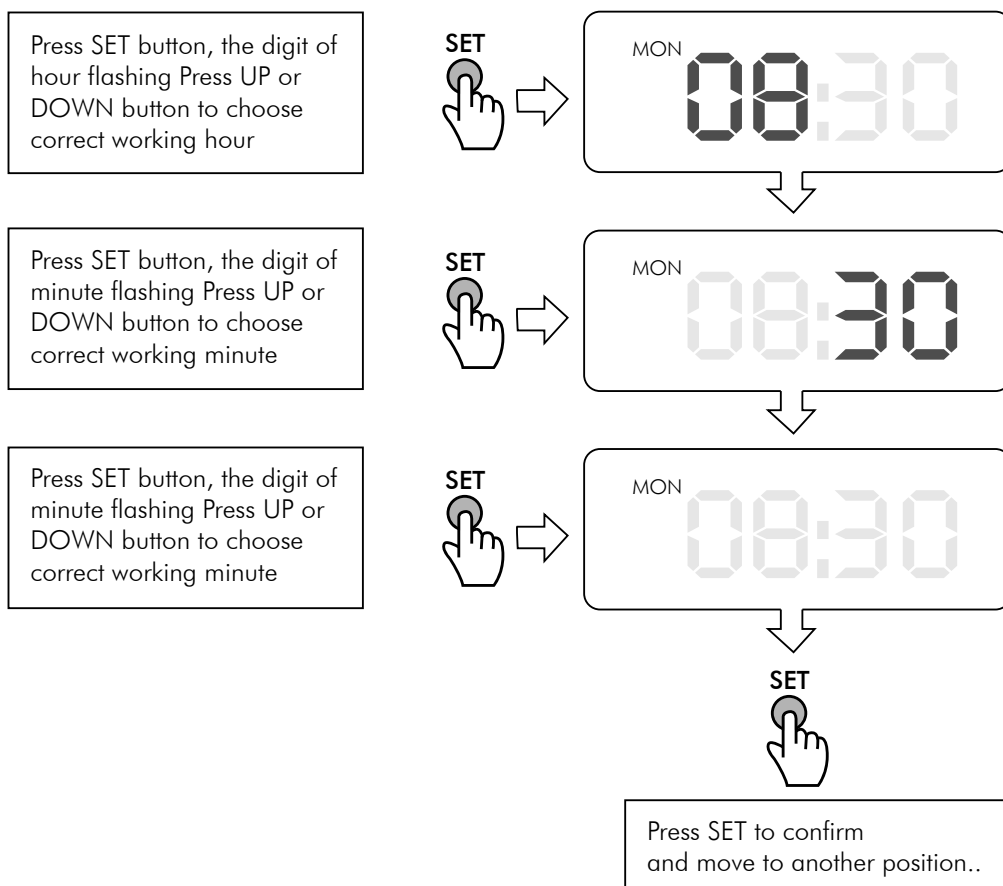

Setting Scent Intensity

You are now ready to start scenting. Remember, the ScentPro is a high performance adjustable device capable of scenting spaces from 100 to 4,000 sq.ft. Once the fragrance is in the device, basic operation is simply adjusting the scent level to match the room size, conditions, and your taste.

Using the belowing method to control the scent intensity.

Start at minimum and watch the scent spread through out your space. If needed, adjust the buttons to increase or decrease the intensity accordingly.

This is a unique and powerful performance feature of the ScentPro. Once you have chosen the right setting, you should only have to adjust slightly with the different fragrances.

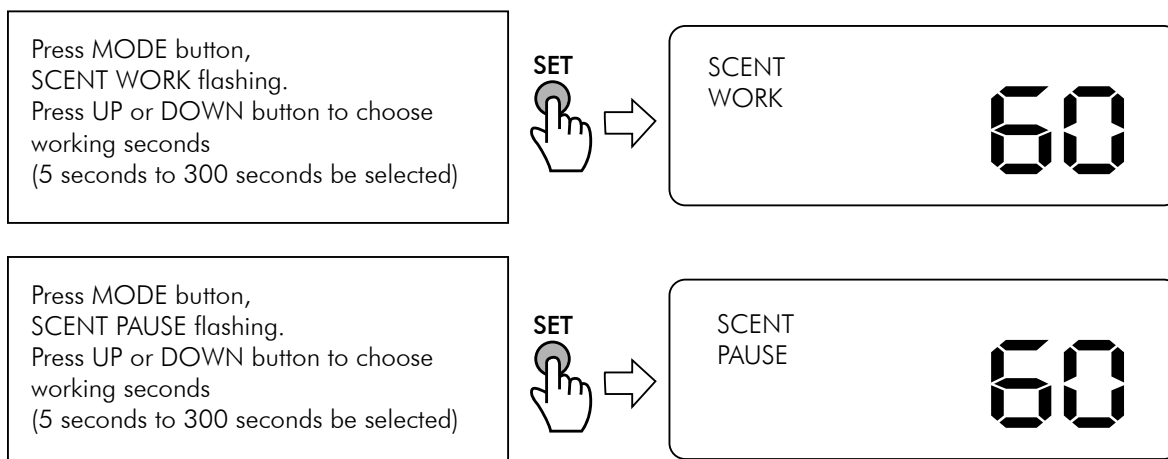

Recommended Intensity Settings.

Start the Scent Pro diffuser with lowest setting (recommends 30 seconds on, 300 seconds off).

To increase the intensity, reduce the diffusion time to different levels and check if the perfume strength reached to the desired level. To get maximum intensity, increase the diffusion and reduce the off time. Short but frequent bursts are also recommended. Using the lower settings will allow for a subtler scenting experience without being over strength.

Please be aware that intensity setting is personal and depends on multiple factors, such as air flow, the location of the scent machine and how subtle or strong you want the scent to be. Always recommend to start with lower level and increase gradually as required.

To test if the intensity is too strong or light, leave the scented area for at least 5 minutes and re-enter after getting some fresh air. Only then will you be able to feel if the intensity level needs to be adjusted up or down.

Please note that the human nose gets used to a fragrance after 30 minutes and it is called olfactory adaption. If at any point during the diffusion process you don't smell the scent anymore, simply leave the scented area and reenter after getting some fresh air.

Setting working groups

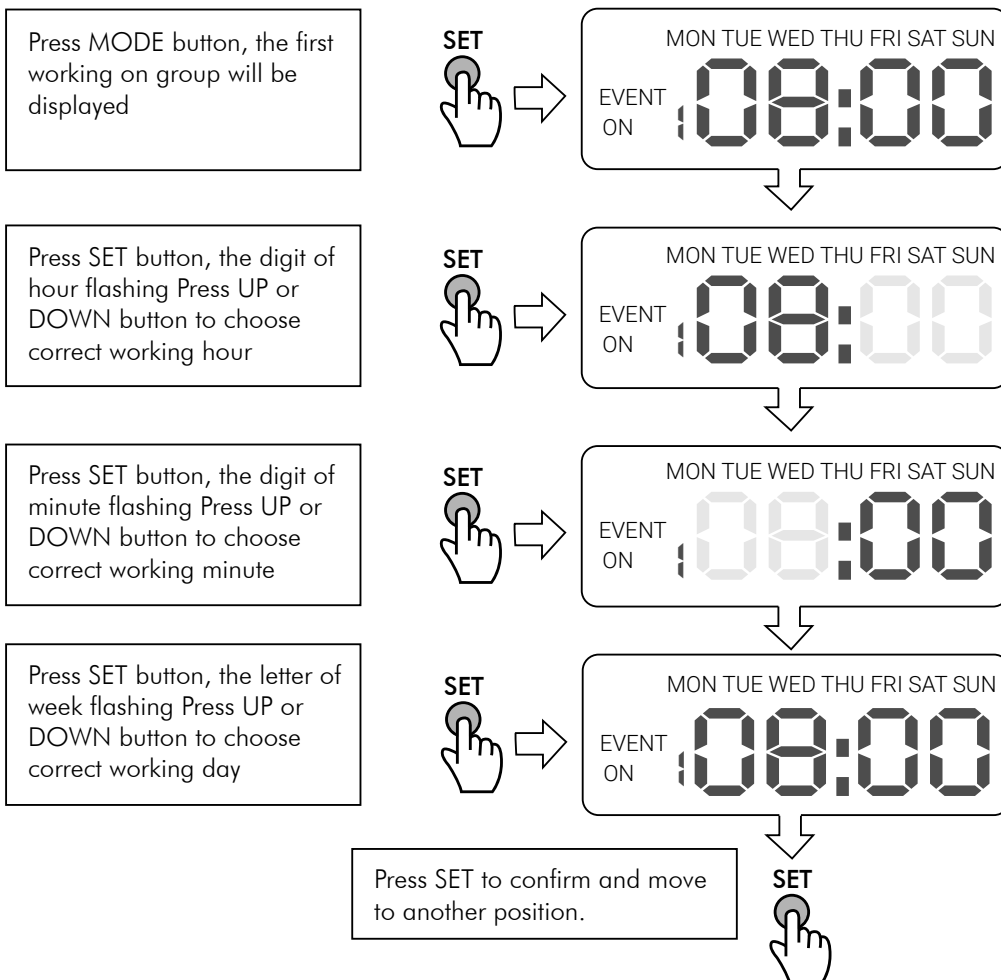

Setting working groups

Press MODE button to enter first working off group setting. Press SET button, the digit of hour flashing. press UP or DOWN button to choose correct working off hour

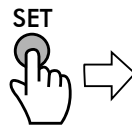

Press SET button, the digit of minute flashing. Press UP or DOWN button to choose correct working off minute

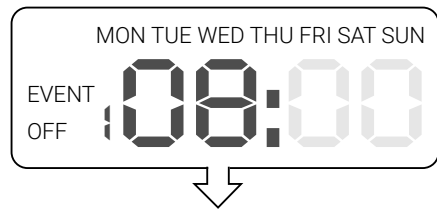
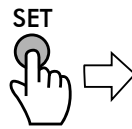

Press SET to confirm and move to another position.

(The first working period is set to factory default setting, 7 am ON and 21:00 OFF. The rest are at set to 00:00)

Available working period	07:00 21:00	00:00 00:00	00:00 00:00	00:00 00:00	00:00 00:00
MON	ON/OFF	ON/OFF	ON/OFF	ON/OFF	ON/OFF
TUES	ON/OFF	ON/OFF	ON/OFF	ON/OFF	ON/OFF
WED	ON/OFF	ON/OFF	ON/OFF	ON/OFF	ON/OFF
THUR	ON/OFF	ON/OFF	ON/OFF	ON/OFF	ON/OFF
FRI	ON/OFF	ON/OFF	ON/OFF	ON/OFF	ON/OFF
SAT	ON/OFF	ON/OFF	ON/OFF	ON/OFF	ON/OFF
SUN	ON/OFF	ON/OFF	ON/OFF	ON/OFF	ON/OFF

MAINTENANCE

Machine cleaning:

1. We recommend cleaning the ScentPro every 2 months.
2. When changing oil clean out the diffuser.
3. If scent diffusion becomes weak, cleaning is recommended.

Cleaning steps:

1. Empty the oil from a canister and replace with 20ml of rubbing alcohol
2. Screw the bottle into the diffuser and turn the machine ON for 20 min to clean out the diffuser head and tube.
3. Pour out the rubbing alcohol (no rinsing required) and replace with your favorite aroma oil blend.

Tips:

You can start using the scent machine immediately after cleaning it. There is no need to wash the tube.

IMPORTANT

- After installation make sure the diffuser, bottle and pump box are ALWAYS vertical and not tilted or on its side.
- When the machine is on pause and not diffusing the atomization icon will be displayed.

TROUBLESHOOTING

Before submitting a warranty claim, please try the below steps to diagnose the problem and fix the issue. For warranty information, please contact Aroma 24/7 at +971 4 2860960 or send us an email at help info@aroma-247.com

Problem	Solution
No diffusion	<ul style="list-style-type: none"> • Check if the power is ON or OFF. • The pump is damaged and needs replacing. • If there is no diffusion or it is weak, replace the oil with rubbing alcohol and run it through the machine for 5 min.
Little or no spray coming out	<ul style="list-style-type: none"> • Atomization head is blocked. Clean diffuser by running rubbing alcohol through it. Or replace diffuser core. • Diffuser core with straw is missing or damaged. Replace with a new one • Pump is damaged and may need replacing.
Diffuser spraying liquid	<ul style="list-style-type: none"> • Diffuser core is damaged. Replace diffuser core. • Machine is tilted or angled. Make sure it's upright at all times.
Oil leaking	<ul style="list-style-type: none"> • Bottle is loose. Screw it in properly and straight. • Seal is broken or missing. Replace the supplied seal that came with the machine.
Abnormal sound	<ul style="list-style-type: none"> • Bottle is loose. Screw it in properly and straight. Seal is broken or missing. • Replace the supplied seal that came with the machine.
No display on screen	<ul style="list-style-type: none"> • Make sure the power is ON. Press SET for 5 seconds. Check the plug for damage. Try another outlet. If plug is damaged replace. • Display screen is damaged. Replace.

CAUTIONS

- Only use the power adapter supplied with the device.
- Never operate the diffuser if the power adapter is damaged.
- Do not use the diffuser if any part of the device is broken.
- To reduce the risk of electric shock, do not attempt to service the device in any way other than as described in the "Care & Maintenance" section of this manual.
- Do not disassemble or attempt to repair the diffuser; in the event of a problem, please contact us at +971 4 2860960 or email info@aroma-247.com
- When moving the device, always keep it upright and secure with both hands.
- Always place the unit on a stable, level surface, i.e., shelf or a table.
- Do not plug the unit into the wall socket with wet hand
- Do not pour water or other liquids into the bottle with aroma oil.
- Do not tilt, move, or attempt to empty or refill unit while in operation.
- To prevent clogging of the diffuser, run rubbing alcohol once a month for 15 min.
- Always turn off and unplug the device during maintenance or when not in use.
- Ensure that the power adapter is not covered or blocked when plugged in; it must be able to dissipate the heat properly.
- Do not cover the diffuser with objects or material while in use.
- Use only aroma 24/7 diffuser blends; other oils may contain fragrances, base oils or synthetics that could result in malfunction..
- In case of smoke, unusual scent, loud noise, or other malfunction, unplug the unit immediately and discontinue use. Further use may result in fire or electrical shock.
- Do not immerse the unit in water.
- Always keep unit out of reach of small children and pets.
- Store at 0°C -50°C (32°F-122°F) and 5%-95% humidity.

CAUTION: Always be cautious of where you place the ScentPro. Make sure it cannot be tipped over as that may cause some aroma oil to leak out. Keep out of reach of children. Avoid getting aroma oil liquid in contact with wood or other delicate surfaces.

NOTE: Do not place the ScentPro near an HVAC return grill, exhaust fan or vent, open door or a window as that will cause the scent to escape the space. Remember you want to work with the natural airflow not against it.

IMPORTANT: Keep nose clear from fragrance output when the device is operating. Instead, wave air towards nose to experience fragrance.

TIP: As a rough estimate, start with diffusion time less and off time high. Increase the diffusion time and decrease the off time based on required intense. Always try to set mild to medium for best scent experience.

FAQS ScentPro

Q: What size room can ScentPro handle?

The ScentPro is fully adjustable for different size areas. It is most effective in spaces from 100 to 4,000 square feet (10 to 400 square meters). Depending on the essential or aroma oil you use it may cover more area since some oils are more potent than others. Ideal for scenting large spaces such as living rooms, large bedrooms, office space or even an entire home, ScentPro is the most potent and discrete diffuser on the market.

Q: Where can I place the ScentPro?

You must place the ScentPro on a flat surface where it can take full advantage of the natural airflow in the space. If placed on the tabletop or a shelf, make sure it doesn't tip.

Alternatively, you can wall mount it. When wall mounting the ScentPro, make sure it is secured properly and is at least 6 feet off the ground and 20" from the ceiling. Refer to the User Manual for more details

Q: Do I need to adjust ScentPro?

Yes! ScentPro is a very powerful device that can handle small and very large spaces. If it is set too high for the room size, it can cause discomfort for some people. Adjusting scent intensity is easy. Simply touch the SET, up and down button on the device to set interval time, working seconds and pause seconds

Q: How strong should I make the scent?

Remember, less is more. The ScentPro allows you to get rid of bad odors and create a unique ambiance with small amounts of scent. Unlike other air fresheners, the ScentPro can be adjusted with a simple touch. Human noses become used to scent very fast, so if you don't smell the scent anymore, that doesn't mean it's not there. Simply leave the scented area and re-enter with a fresh nose to get a better feel of how strong it is.

Q: What is the capacity of the ScentPro bottle?

The ScentPro uses a 300ml bottles. The fragrance diffuser is designed only to take Aroma 24/7 bottles specific to the diffuser.

Q: How long does the fragrance oil last in the bottle?

The ScentPro uses a 300ml bottle of essential or aroma oil that will last 3-4 weeks with daily usage running about 12 hours a day. To preserve the essential oil, we highly recommend using the internal 24/7 timer and set it up so that the diffuser doesn't run at night. Depending on the essential oil you are using that time may increase or decrease. Some essential oils diffuse a lot faster due to their consistency and viscosity.

Q: What is the average oil consumption of the ScentPro?

Oil consumption strongly depends on the essential or aroma oil used. Essential oils diffuse faster than aroma oils. Average oil consumption ranges from 1ml-2ml per hour.

Q: What if my unit does not turn on?

Check to make sure the power adapter is correctly plugged into the DC power jack and the electrical source. If hours of operation timer is set incorrectly and you are trying to diffuse during the time that the machine is programmed to be off the ScentPro will not scent.

Q: How do I unlock the LCD if it is locked and I can't control the device?

ScentPro's intuitive timer is designed to lock itself (shut off) after 10 seconds if not in use. To unlock the display simply press and hold the SET button for 5 seconds.

Q: What if my unit does not scent or there is almost no scent coming out?

Check first that there is aroma oil in the bottle and the bottle is screwed in straight and snug. If there is fragrance in the bottle but you still don't smell anything then either the device is in rest or pause mode, turned off, or the diffuser core is clogged and needs cleaning. Please see "Care & Maintenance" instructions..

Q: Will the ScentPro cover my entire house?

It can, but it depends on how big your house is and how many air handlers you have in your home. The separation wall between the rooms can block the airflow and hence the fragrances reaching other rooms.

Q: What if my house is larger than 4,000 square feet?

In this case, we recommend switching up to the Air Scent Single or Duo. It's a very powerful HVAC scent machine that is capable of scenting spaces up to 15,000 square feet.

Q: What type of oils can I put in my home diffuser?

Use only Aroma 24/7 diffuser blends; other blends and oils may contain base oils that could result in clogging the device. Many single note essential oils should not be used in the diffuser. Single note essential oils may have a thick or heavy consistency that can clog the diffuser and cause it to stop diffusing scent. Aroma 24/7 diffuser blends have been carefully blended to be effective for you, and safe and easy to use in your cold-air diffuser.

Q: Is ScentPro safe to use with children and pets?

Yes. When used as directed and only with Aroma 24/7 essential and aroma oil blends, ScentPro is the safest cold-air diffuser available. Make sure to request SDS if you require more info about the oil being diffused.

Q: Is ScentPro Diffuser Eco-Friendly?

Aroma 24/7 diffusers are the most Eco-friendly made products on the market. Unlike aerosols, the ScentPro uses no propellants, phthalates and produces no harmful volatile organic compounds (VOCs). Unlike many air fresheners, ScentPro uses no ethanol or similar solvent to enhance the evaporation of essential and aroma oils.

Q: Warranty and Support?

All products designed by Aroma 24/7 come with a 1 year limited warranty. If you have any questions or issues, simply contact us at +971 4 2860960 or email info@aroma-247.com